

# Utilizarea kit-ului de igienizare Pureal

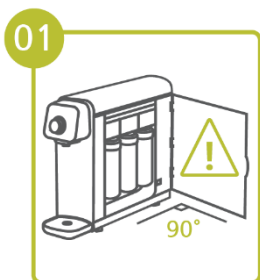

01 Deschideti usa de acces

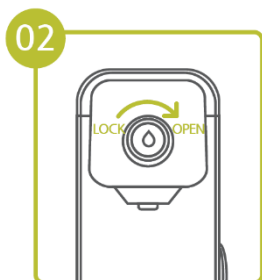

02 Deschideti robinetul si lasati apa sa curga pana se opreste

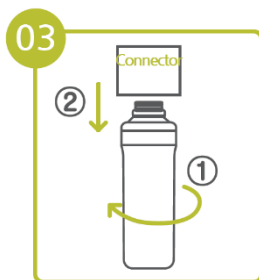

03 Scoateti cele 3 filtre

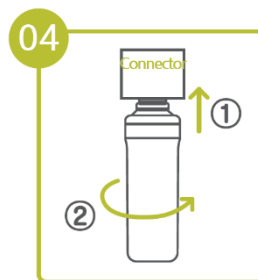

04 Conectati filtrul de igienizare in locul primului filtru

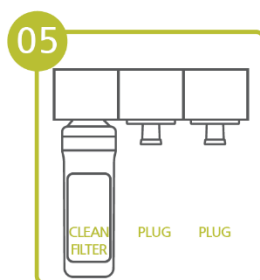

05 Conectati dopurile in locul filtrelor 2 si 3

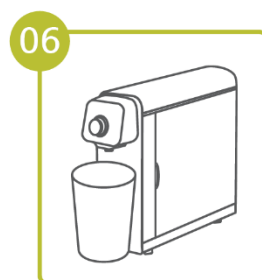

06 Plasati un recipient pentru a putea scoate 2l de apa si inchideti usa de acces



07 Dispense 2Liters  
Dupa scurgerea celor 2l de apa, inchideti robinetul



08 Wait for 5mins  
Asteptati 5 min ca solutia sa actioneze

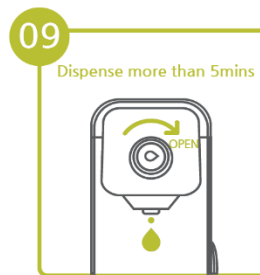

09 Dispense more than 5mins  
Deschideti robinetul si lasati sa curga apa timp de 5 min

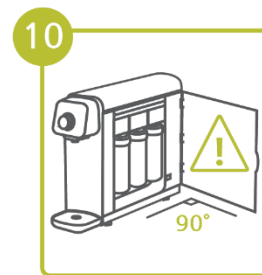

10 Deschideti usa de acces

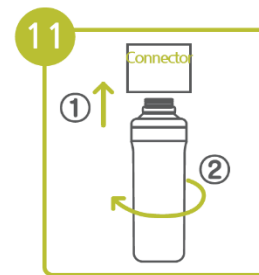

11 Deconectati filtrul de igienizare si dopurile

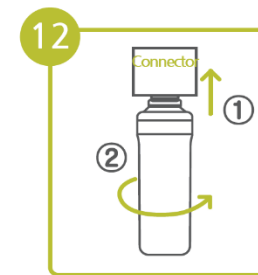

12 Inlocuiti si conectati noile filtre corespunzator



13 Verificati montarea si ordinea corecta a filtrelor

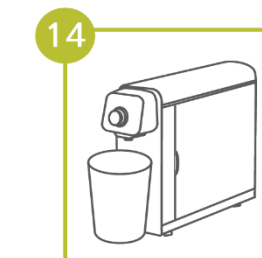

14 Amplasati un recipient si inchideti usa de acces



15 Deschideti robinetul si lasati sa curga apa timp de 5 min



16 Inchideti robinetul. Procesul de igienizare este finalizat